

## FILTROMATIC

### AUTOMATIC WATER SELF-CLEANING FILTERS

FLOW RATE UP TO 9000 m<sup>3</sup>/h

| SIZE | DIMENSIONS mm. |      |      |     |      |      |        | Weight<br>Kg. |
|------|----------------|------|------|-----|------|------|--------|---------------|
|      | A              | B    | C    | D   | E    | F    | IN-OUT |               |
| 5000 | 5350           | 1900 | 3150 | 600 | 1050 | 1650 | 34"    | 7600          |
| 7000 | 5800           | 2100 | 3550 | 600 | 1150 | 1850 | 40"    | 9500          |
| 9000 | 6150           | 2350 | 3850 | 600 | 1300 | 2080 | 46"    | 12400         |

### AUTOMATIC SYSTEM

FILTROMATIC is equipped with an high reliable control system able to manage automatically the backwashing cycle to regenerate the filter elements.

The progressive accumulation of the retained debris causes an increase of differential pressure drops between inlet and outlet fluid pressure; when the pre-determinate set point is reached, the differential pressure switch activates the backwashing cycle which calls for the opening of the drain valve and the rotation of the backwashing arm.

The slide valve mounted on the arm seals off each filter elements from the filtration phase and put it in communication with atmospheric pressure: a small part of filtered water is forced in reverse direction carrying away the debris previously retained by the filter element through the opened drain valve.

The clean water pressure must exceed 1 bar in order to obtain an effective regeneration of the backwashing operation.

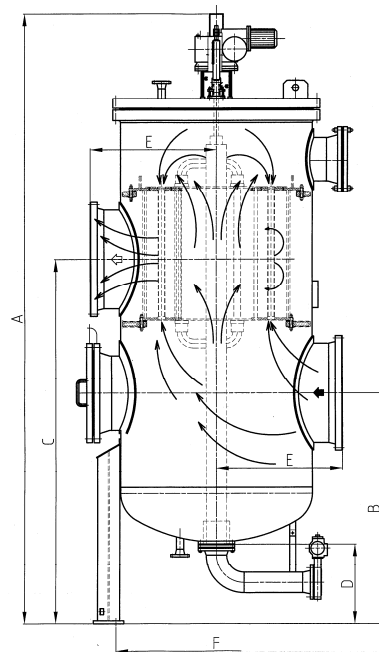

### BENEFITS

- Backwashing without flow interruption
- Effective restore by backwashing
- Larger effective filtering surface reduces the frequency of backwashing cycles
- Rugged corrosion-proof filter elements
- Low water usage for backwashing operation
- Simply design provides lower maintenance cost

### AVAILABLE FILTRATION RATINGS

Standard: 125-250-500-1000-2000 micrometers  
Upon request: 750-1500 micrometers

### EUROPEAN DIRECTIVES

The FILTROMATIC meets Machinery Directive 2006/42/CE (and its updating) and is supplied with the installation and maintenance manuals with all the prescriptions for a safe handling of the equipment. Other Directives like PED & ATEX can be met, whenever applicable.

Data contained in this bulletin are informative and subject to change without prior notice.

User is responsible for determining whether the product is fit for particular purpose and suitable for User's method of application.